

INSTALLATION INSTRUCTIONS

FOR MOST PENDANT FIXTURES

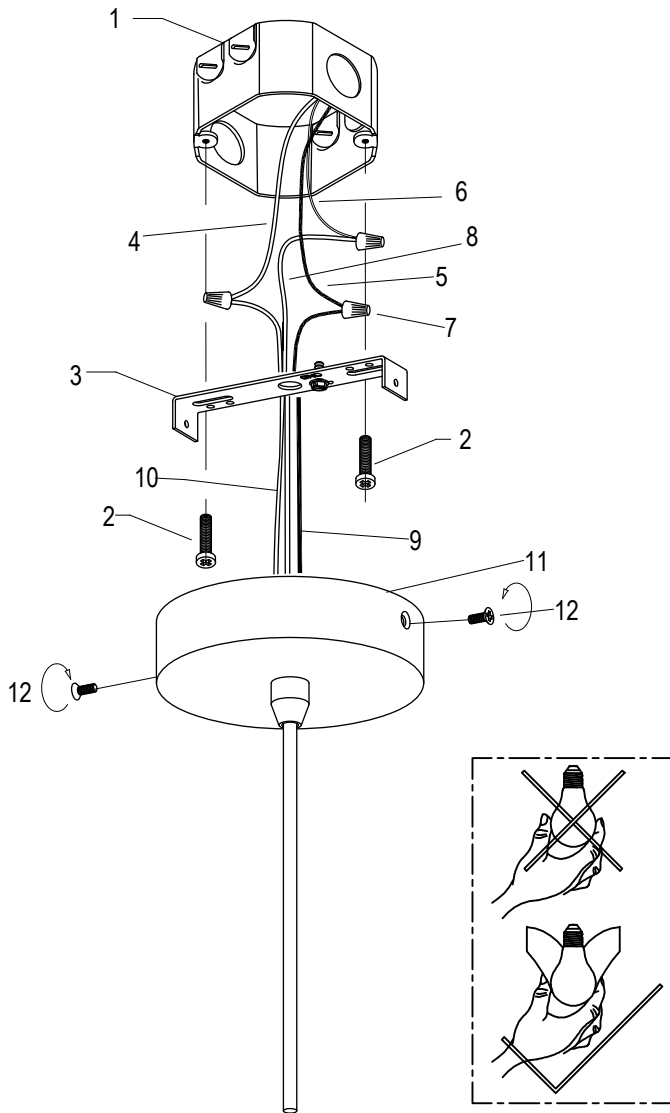

READ INSTRUCTIONS AND REVIEW ALL DIAGRAMS BEFORE INSTALLING FIXTURE

GENERAL INSTRUCTIONS:

1. All electrical connections must be in accordance with local codes, ordinances and the National Electric Code.
2. These fixtures should be mounted on electrical outlet box. The box must be directly supported by the building structures.
- 3: Turn off the circuit breaker or remove the appropriate fuse to disconnect power source before installing fixture.
4. Turning the light switch off to cut the power is not sufficient to prevent electric shock.

TO INSTALL:

- Turn electricity off at fuse box by removing fuse or turning the circuit breaker off.
1. If you are replacing an existing fixture, disconnect and remove the old fixture. Expose the supply wiring from the outlet box.
 2. Using the diagram to the right as a mounting guide, mount the fixture*.

ELECTRICAL CONNECTION:

Connect the fixture wires to junction box wires as shown. Black to black, white to white, and bare/green to bare/green. Make sure that all wire connectors (7) are secure. Secure wires with CSA and UL listed electrical tape. If your outlet box has a green or bare copper ground wire, connect the bare copper wire from the fixture to it. Otherwise, connect the fixture's ground wire directly to the back plate using the green screw. After wires are connected, tuck them carefully inside the junction box. Attach canopy to mounting bracket using the included canopy screws (12).

*Actual fixture may vary from image shown.

- | | |
|------------------------------|-------------------------|
| 1. OUTLET BOX (NOT INCLUDED) | 7. WIRE NUT |
| 2. MOUNTING SCREW | 8. WHITE FIXTURE WIRE |
| 3. MOUNTING BRACKET | 9. BLACK FIXTURE WIRE |
| 4. WHITE SUPPLY WIRE | 10. FIXTURE GROUND WIRE |
| 5. BLACK SUPPLY WIRE | 11. CEILING PAN |
| 6. SUPPLY GROUND WIRE | 12. SCREW |

TO ASSEMBLE:

1. Spread the electrical splices to the black wires on one side of the outlet box, the white wires on the other.
2. Install light bulbs (not included) according to fixture's max wattage rating label.
3. Turn power on and make sure the light fixture is working properly.